

# NOVOGRADNJA B E Z D A N J A

VIŠEPORODIČNA STAMBENA ZGRADA P+2+PK  
FILIPA KLJAJIĆA 10, SOMBOR

## STAN BR. 17

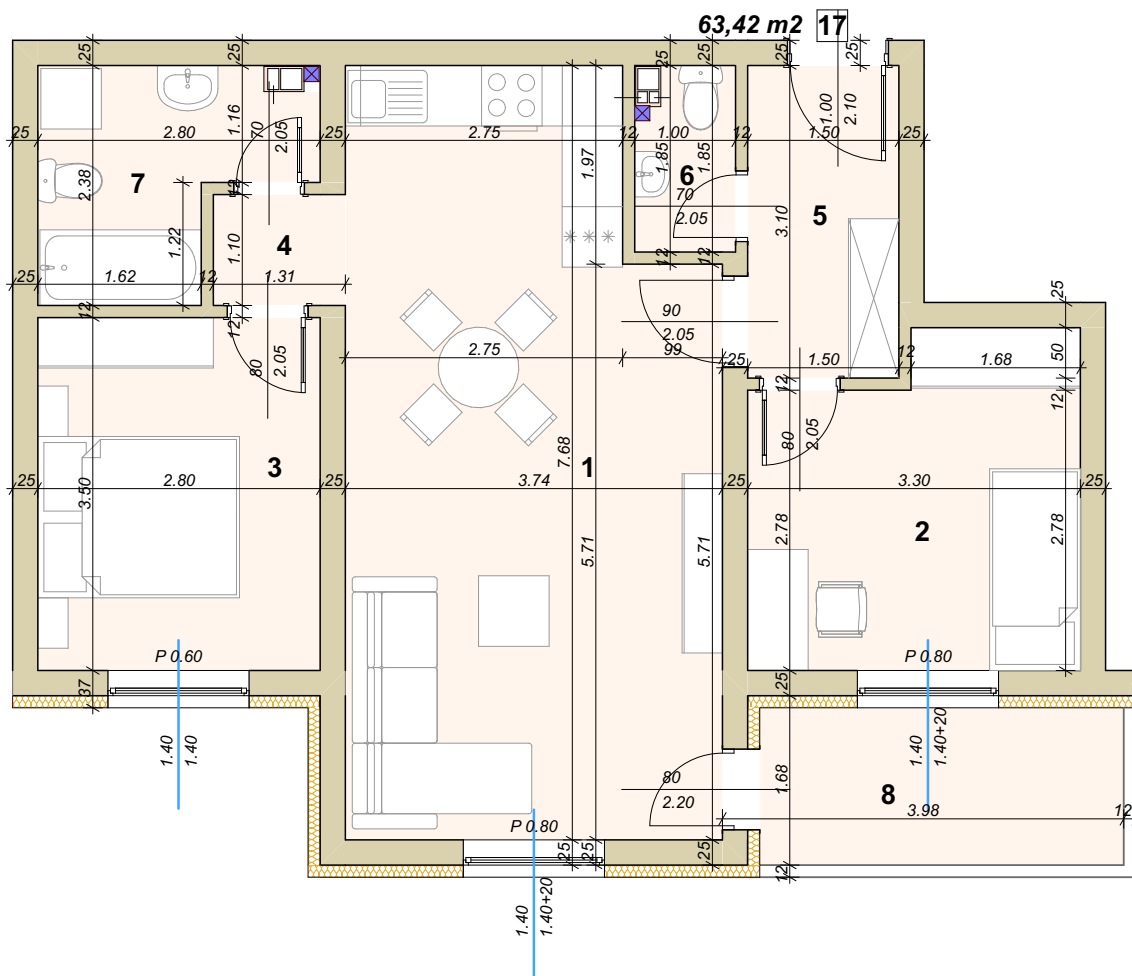

<b>STAN BR. 17 - TROSOBAN STAN</b>			
<b>POTKROVLJE</b>			
	<b>PROSTORIJE</b>	<b>POVRŠ.</b>	
1	Dnevna/Kuhinja/trpezarija	26.78 m <sup>2</sup>	k.p./parket
2	Soba	10.22 m <sup>2</sup>	parket
3	Soba	9.80 m <sup>2</sup>	parket
4	Degazman	1.44 m <sup>2</sup>	parket
5	Hodnik	4.65 m <sup>2</sup>	keram.ploče
6	WC	1.72 m <sup>2</sup>	keram.ploče
7	Kupatilo	5.08 m <sup>2</sup>	keram.ploče
8	Terasa	5.63 m <sup>2</sup>	keram.ploče
	<b>UKUPNO</b>	<b>65,38 m<sup>2</sup></b>	
		<b>-3%</b>	<b>63,42 m<sup>2</sup></b>